

# AquaLIGHT 112

Single Light Option with White Variants

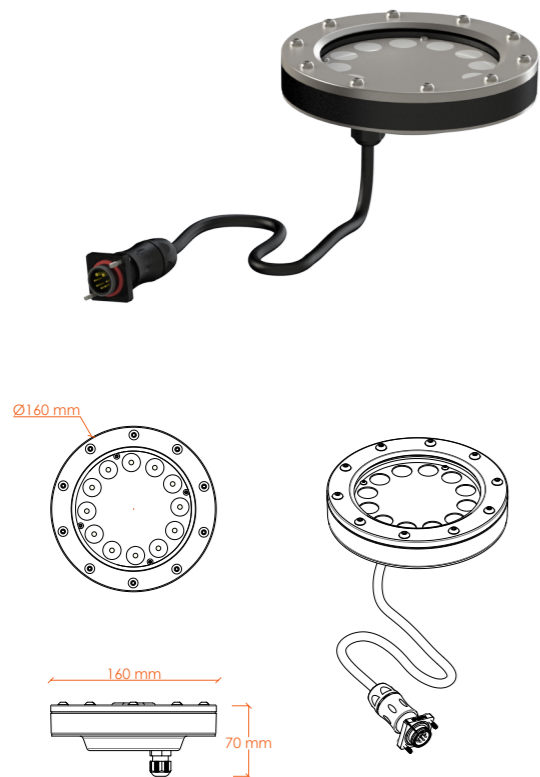

Our established lights incorporate energy-efficient LED plates that deliver superior illumination. AquaLIGHT 112 provides a single light option with different white variations (wW, W, cW). This lighting solution is particularly effective for open space fountains. This powerful unit enhances brightness in dark areas and is suitable for larger fountain installations. It efficiently illuminates individual fountains and water features.



- ✓ CREE / Edison PowerLED
- ✓ Driver circuit onboard
- ✓ Aluminium PCB
- ✓ IP68
- ✓ Robust stainless steel
- ✓ Tempered glass
- ✓ DMX + RDM controlled
- ✓ Synchronorm Depence Library available

# AquaLIGHT 112

## Lighting Angle:

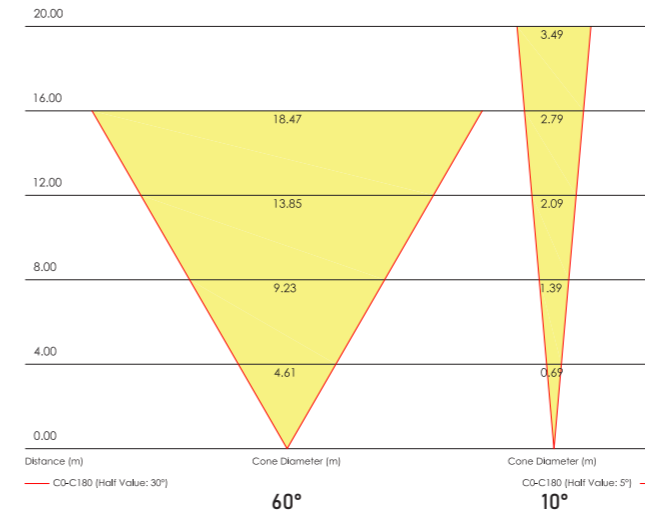

! In lighting, choosing the lens angle is as important as selecting the color or wattage. Small angles retain brightness at long distances, while wide angles cover larger areas but lose brightness over distance.

## ACCESSORIES

PRODUCT	ORDER NO
BlackBox :	5022
Combo Cable :	page
ByPass Terminal :	page
Holder U Profile :	1201
Holder Lighting :	1203
Multi Lighting Kit 2 :	1206
Multi Lighting Kit 3 :	1207

## Holder U Profile Schematic :

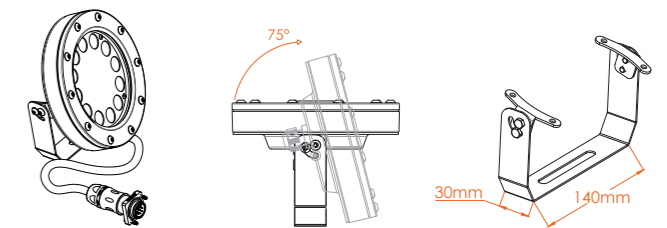

## TECHNICAL DETAILS

MODEL :	AquaLIGHT 112
DIMENSION (ØxH) :	160 x 70 mm
VOLTAGE :	24 VDC
POWER :	18 W
CURRENT :	0.8 A
COLORS :	wW / W / cW
POWER & DMX :	Combo Cable
LUMINOUS FLUX RGB FULL :	1440 lm
WEIGHT :	0.8 kg
PRODUCT NO :	3020

